

Green Profile: Linden Academy (K-5)

Linden Academy (K-5) is home to a well-kept outdoor classroom area, a variety of shrubbery, and numerous young trees.

'Green Velvet' boxwood shrubs surround the outdoor classroom. These shrubs are a deep green color and hold a square-ish shape.

Arrowwood viburnum line the school's back slope. These shrubs produce a creamy white flower in late spring or early summer.

Number of plants planted:

16 Trees

71 Shrubs



About the Green Profile

Funded by The Grable Foundation, the Western Pennsylvania Conservancy's School Grounds Greening Project brings children closer to nature by enhancing the grounds of Pittsburgh Public Schools with greenery and outdoor green spaces.

The Green Profile is a fact sheet that highlights the projects WPC has completed at each of the Pittsburgh Public Schools.



The Benefits of Greening



Educational Benefits

Linden's outdoor classroom provides students with the opportunity to learn in an open-air setting. Surrounded by boxwood shrubs, crabapple trees, and honeylocust trees, natural stone benches form a semi-circle seating area. This shady space is ideal for teachers to hold self-directed reading time or outdoor science labs, or to teach lessons of any kind.

Beautification

'Red Sunset' maple trees provide a natural, colorful border along the Wilkins Avenue fence. A row of eastern redbuds extends the school's pre-existing tree line next to the parking lot, creating additional shade and beauty.



Environmental Benefits

The 16 trees planted at Linden are currently 2" in diameter. If they are well cared for and grow to 8", they have the potential (per year) to:

Absorb 9,020 gallons of storm water runoff

Conserve 571 kilowatt hours of electricity by cooling the building

Reduce atmospheric carbon by 3,124 pounds

\$791 in annual benefits!

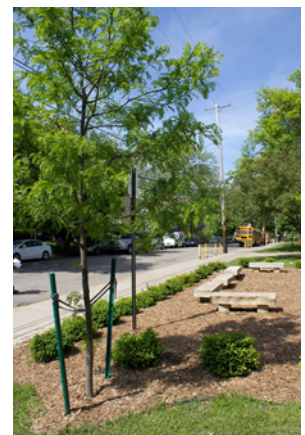

Calculations provided by www.treebenefits.org